

Pro Cyc® PC80 Portable Green Screen Setup Instructions



MISSION STATEMENT

Pro Cyc®, Inc. is the world leader in design and sales of modular cycloramas and green screen systems. Our mission is to work closely and ethically with our suppliers, employees and strategic partners in a concerted effort to provide our customers with the highest-quality, cost-effective, custom solutions that will meet or exceed any technical requirements for the broadcast-video, motion-picture or photography industries.

PC80 Setup Instructions

Take care when unpacking your Pro Cyc® Portable Green Screen to avoid scratching, bending or damaging the surface of the green material.

Your contents include: (Fig. 1)

- 1 each: 80” wide x 24’ long strip of Pro Matte® IV
- 1 each: 80” long, white, two-part Pro Matte® IV background support crossbar; including:
 - 1 each: 80” long, white crossbar bottom part w/ rubber stripping
 - 1 each: 80” long, white crossbar top
- 15 thumb screws
- 4 each: 1/2” flat washers
- 2 each: 1/2”-13 hex nuts

**Note: The PC80 MUST be placed on a clean, flat, hard surface (e.g. wood or concrete). The PC80 is not meant to be used on carpet of any kind. Debris left under the Pro Matte® IV material may cause defects in the surface of the flooring.*

3. Getting Pro Matte® IV Ready:* Carefully unroll and position the strip of Pro Matte® IV with the textured side up and with the head of the strip in approximate position for lifting to top of American Grip stands.

**Note: Do not bend or fold Pro Matte® IV during handling*

4. Squaring the Top: Use scissors or straight edge to square the top end of Pro Matte® IV.

5. Putting the Pro Matte® on the Background Support Crossbar: At the head of the Pro Matte® IV, lay the 80” white crossbar bottom piece (with rubber stripping) with threaded inserts toward the floor and *away* from the Pro Matte® IV. Carefully lay the top end of Pro Matte® IV on top of the spongy rubber stripping material on the bottom crossbar, leaving just the holes exposed for thumbscrews (Fig. 2).

Place the 80" white crossbar top over the bottom crossbar so that the Pro Matte® IV is between the top and bottom crossbars, being careful to line up the holes. All holes should line up at this time (Fig. 3).

Loosely secure crossbar top to the crossbar bottom using the thumbscrews (Fig. 4). Do not tighten yet; the Pro Matte® IV should still be able to move between the crossbars.

6. Tighten Thumb Screws: Gently push Pro Matte® IV between the top and bottom crossbar pieces against the thumbscrews to make sure that it is straight and aligned across the entire length of the crossbar. Tighten all thumbscrews to secure the Pro Matte® IV. Finger tight should be enough.

9. Creating the Sweep Radius: At the leading edge on the floor, pull the Pro Matte® IV forward until a gentle radius is created at the transition between vertical and horizontal. Once you are satisfied with the sweep to the floor and alignment of the Pro Matte® IV, weight it down with sandbags or with double stick tape on the underside of the material. (See final photo of completed setup.)

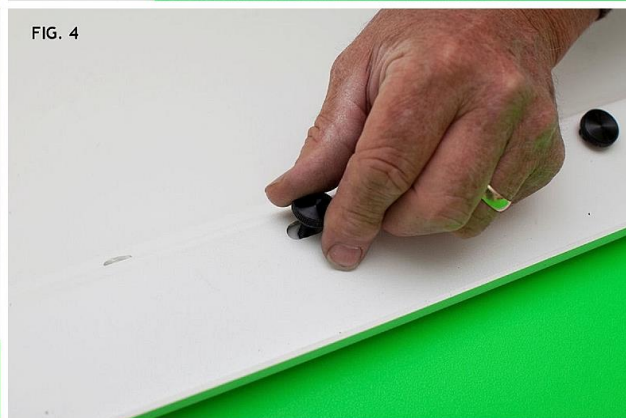

Pro Cyc® PC80-NS (No Stands) Supplemental Setup Instructions

Setup Option 1 – Using Junior Stands Supplied By You:

See the supplied PC80 Setup Instructions.

If you already have two junior stands you can use the two supplied Junior Stand Adapters (as shown in the photo below) to mount your PC80-NS on your existing junior stands.



Setup Option 2 – Mounting To Gypsum Drywall:

In addition to the materials listed on the supplied PC80 Setup Instructions (and the two Junior Stand Adapters mentioned in Setup Option 1) your PC80-NS also includes:

- 4 each: 5/16" x 4" Lag Screws
- 4 each: 3/8" x 1-3/4" Lag Screws
- 8 each: 5/16" Flat Washers
- 2 each: 1/2"-13 x 1-1/4" Hex Cap Screws
- 2 each: 1/2"-13 Hex Nuts
- 2 each: Angled Mounting Brackets

Materials and Tools Not Supplied by Pro Cyc:

If you intend to attach your PC80-NS to a wall (without using stands) you should make sure you have a block of wood to attach the supplied angled mounting brackets to. Pro Cyc recommends using Premium #2 and Better Douglas Fir Lumber (or equal) 2" x 6" x at least 7' 2" long. The block can be painted before installation for aesthetic purposes.



In addition to the 2" x 6" block of wood, you will also need the following tools:

- 1 each: Stud Finder
- 1 each: Electric Drill
- 1 each: 15/64" Drill Bit
- 1 each: 5/16" Drill Bit
- 1 each: 1/2" Socket Wrench
- 1 each: 9/16" Socket Wrench
- 1 each: 9/16" Flat or Combination Wrench

1. Attach the Wood Block to Your Wall

The block of wood can be attached to the wall using the supplied 5/16" x 4" lag screws with 5/16" washers. One lag screw for every other stud in your wall should be enough to provide a secure mount. Use a stud finder to locate your studs. Use a 15/64" drill bit as a pilot for the lag screws. After using the 15/64" drill bit use a 5/16" drill bit at a depth of about 1/2" to allow clearance for the shank on the lag screw. Use a 1/2" socket wrench to tighten the lag screws.

2. Attach the Angled Mounting Brackets to the Wood Block

The top of the PC80 Crossbar Assembly has 1/2" diameter holes spaced on center approximately 11-1/8" apart. Two of these holes will be used for mounting the PC80-NS to the wood block using the two supplied angled mounting brackets. These angled mounting brackets should be attached to the wood block near each end.

Determine which of the 1/2" diameter holes at the top of the PC80 Crossbar Assembly will be used for mounting. Next, after carefully measuring for position, attach the angled mounting brackets to the wood block using the supplied 3/8" x 1-3/4" lag screws with 5/16" washers. Use a 15/64" drill bit as a pilot for the lag screws. These lag screws should not be tightened all the way. Wait until after the PC80 Crossbar Assembly is installed. This will allow you to adjust the mounting brackets as needed when you are installing the PC80 Crossbar Assembly.



3. Complete Steps 3-6 Shown on the Supplied PC80 Setup Instructions.

This work should be done on the floor directly in front of the wood block mounted on your wall.

4. Attach the Green Screen Assembly to the Angled Mounting Brackets

Next, install the two supplied 1/2"-13 x 1-1/4" long hex cap screws with 1/2" washers and 1/2"-13 hex nuts into the two holes at the top of the PC80 Crossbar Assembly as shown in the photo below. Finger tight is OK. These should be the same two holes that will match the locations of the angled mounting brackets installed on the wood block.



Using two people (one at each hex cap screw) carefully lift the green-screen assembly up to the angled mounting brackets and drop the two bolts through the holes in the mounting brackets. Make sure that you do not fold or crease the Virtual Green® Pro Matte® material during this step.

Attach a 1/2"- 13 hex nut to the bottoms of the two hex cap screws. Finger tight is OK.

Finish tightening the 3/8" x 1-3/4" lag screws into the wood block using a 9/16" flat or combination wrench.

